

# VarioLED™ Flex HYDRA SLD3 White IP67

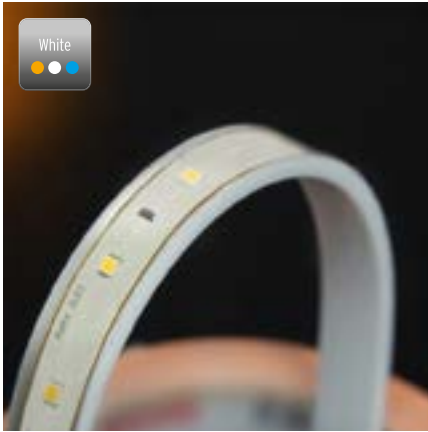

**Up to 133 Lumen/Watt**

- ▶ 2.9 W/m / 0.9 W/ft
- ▶ up to 400 lm/m / 121 lm/ft
- ▶ One Bin Only: 3 MacAdam
- ▶ up to CRI 85

## Dimensions & available lengths

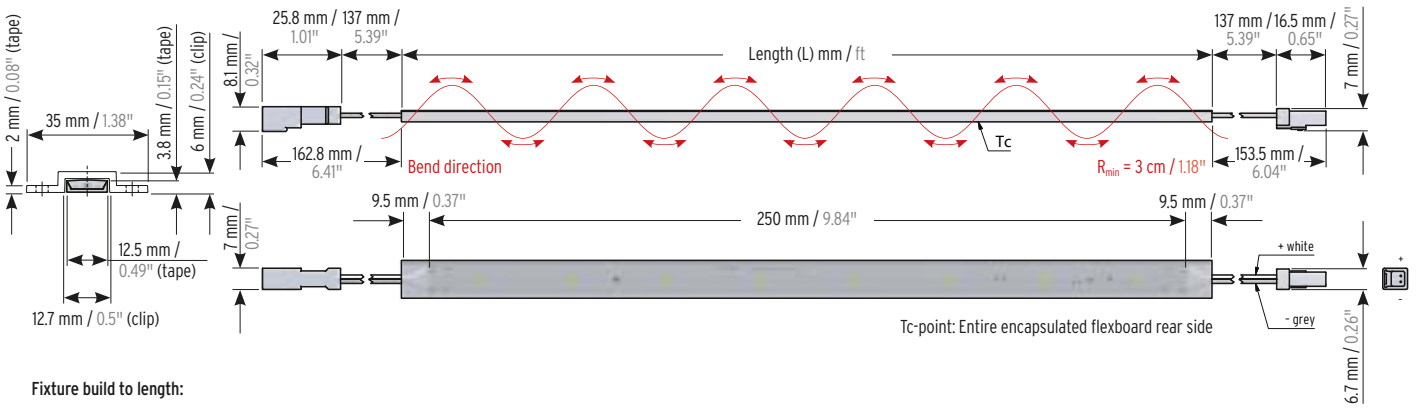

### Fixture build to length:

L<sub>min</sub>: 269 mm; L<sub>max</sub>: 10,019 mm; in 250 mm increments  
 L<sub>min</sub>: 10.59"; L<sub>max</sub>: 32.8"; in 9.84" increments

## Electrical & output data

Step length	8 LEDs per 250 mm / 9.84"
Voltage	24 Volt (23 V <sub>min</sub> , 25 V <sub>max</sub> )
Power (W/m / W/ft) <sup>A</sup>	2.9 / 0.9
Efficacy (lm/W) <sup>A</sup> @ W850	133
max. serial run length (m / ft)	10 / 32.8
Current	1.2 A/30 mA per Step
Temperature <sup>B</sup>	T <sub>Cmin</sub> = -25°C / -13°F, T <sub>Cmax</sub> = 70°C / 158°F
Storage temperature	T <sub>Smin</sub> = -30°C / -22°F, T <sub>Smax</sub> = 85°C / 185°F
Ambient temperature	T <sub>Amin</sub> = -25°C / -13°F, T <sub>Amax</sub> = 40°C / 104°F
CRI / R9 @ W830	up to 85 / up to 25

- ONE BIN ONLY**
- UV protected
- Lifetime L80/B10 > 60,000 h
- Resistant to solvents
- Photometric code Wxxx/339
- Saltwater resistant
- LM 79 compliant
- Temporary immersion protection
- LM 80 compliant

Color temperature LED tape used	Final color temperature delivered for finished fixture	lumen/meter (lm/m) <sup>A</sup>	lumen/feet (lm/ft) <sup>A</sup>
● W820	2,000 K	230	69
● W822	2,200 K	270	81
● W825	2,500 K	310	93
● W827	2,700 K	320	97
● W830	3,000 K	340	103
● W835	3,500 K	360	109
● W840	4,000 K	370	112
● W850	5,000 K	400	121

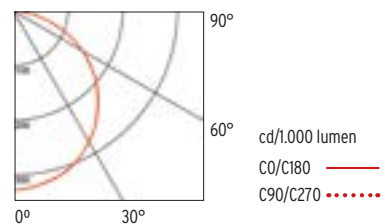

<sup>A</sup> The given data are typical values. Due to tolerances of the production process and the electrical components, values for light output and electrical power can vary up to 10%.

<sup>B</sup> The position of the Tc-point is marked on each step of the LED strip. The Tc-point should be measured in thermal equilibrium according to IEC EN 60598-1.

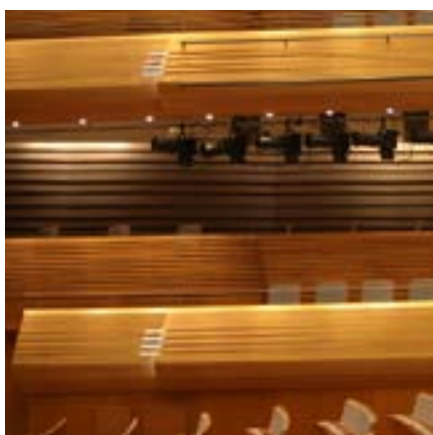

Photo: 000 Desart

IP67 flexible 24 V linear LED strip up to 10 m (32.8") in length. Polyurethane encapsulation offering a premium water proof sealing, UV resistance, chemical stability against urban gazes and protection against abrasion. White lower casing for higher efficiency (better light extraction). Delivered with 200 mm (7.87") IP67 mini connectors on both ends. The first choice for indirect outdoor or humid cove lighting and other non-directly viewed applications requiring IP67 ingress and restricted budget. Constant voltage LED strip with a step measurement of 250 mm (9.84"). Assembled using state of the art automated Reel to Reel (R2R) production process supporting LED Linear™ Tj Away® thin flexible circuit board technology. In combination with ceramic LED packages a thermal resistivity of 15.4 K/W is achieved for an optimal heat dissipation (junction to installation surface)

which guarantees an outstanding lifetime of > 60,000 hrs L80/B10. Each steps embeds 8 high quality japanese LEDs with 3 step MacAdams (SDCM3) binning centered on target CCT (One Bin Only) with an extended photometric code of Wxxx/339 ensuring color consistency over the rated lifetime. Premium color rendition with a CRI of 95 and TM-30-15 up to  $R_f = 91 / R_g = 100$  ensuring a remarkable light quality. Consistent light intensity all along the strip length is obtained thanks to active current regulation operated by dedicated integrated circuits (ICs) on each step. Protected against electrostatic discharge  $\pm 2,000$  V and polarity miswiring. Fully PWM dimmable for frequency > 0 Hz up to 2 kHz (flicker free for frequency higher than 1.2 kHz according to IEEE P1789 standard). Engineered and produced in Germany.

## Order code

Your order code	VarioLED Flex HYDRA	SLD3	W8	---	---	IP67
Order code example	VarioLED Flex HYDRA	SLD3	W8	27	2519	IP67

### Variant

SLD3 ..... SLD3

### Color rendering

> 80 ..... 8

**Final CCT delivered for finished fixture**      **Color temperature LED tape used**

2,500 K ..... 2,000 K ..... 20

2,900 K ..... 2,200 K ..... 22

3,300 K ..... 2,500 K ..... 25

3,800 K ..... 2,700 K ..... 27

4,300 K ..... 3,000 K ..... 30

5,100 K ..... 3,500 K ..... 35

6,100 K ..... 4,000 K ..... 40

9,600 K ..... 5,000 K ..... 50

### Length\*

$L_{min}$ : 269 mm (10.59");  $L_{max}$ : 10,019 mm (32.8');

in 250 mm (9.84") increments

### Ingress protection

IP67 ..... IP67

\*max. lengths product ship with male connector only

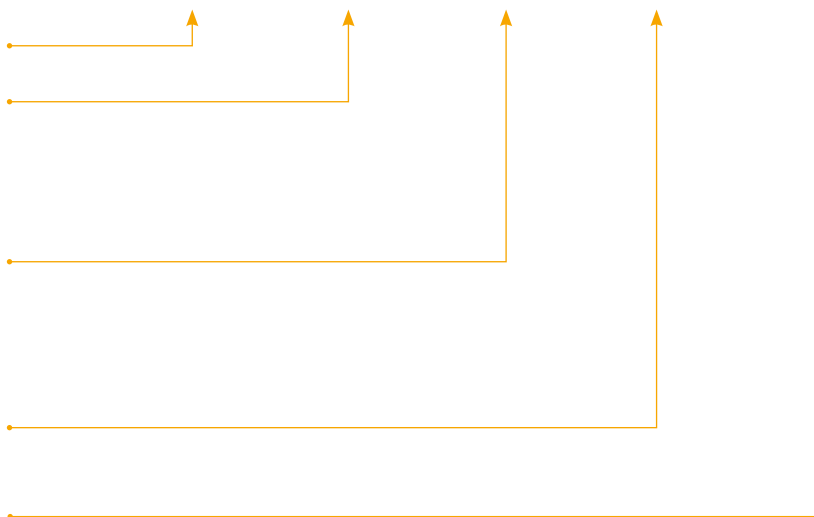

## Please choose your accessories

Mounting	Art.-#
<input type="checkbox"/> VarioClip Flex 12.7 mm / 0.5" Clear (Set of 50)	13000115
<input type="checkbox"/> 3M Adhesive tape	18200035
Lead connector from driver	Art.-#
<input type="checkbox"/> VarioCon Female Mini 2 x 0.34 mm <sup>2</sup> , 2 m / 6.56' IP67	15000142
<input type="checkbox"/> VarioCon Extension Mini 2 x 0.34 mm <sup>2</sup> , 2 m / 6.56' IP67	15000144
<input type="checkbox"/> VarioCon Female Mini Protection Cap Mono IP67	15000218
Recommended power supply	Art.-#
<input type="checkbox"/> Power Supply Unit IP67	16000153

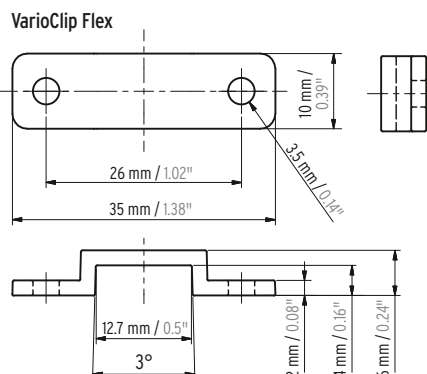

Recommended control unit	Art.-#
<input type="checkbox"/> Control System White/IQ-White	16000268-DT6