

# VarioContour 5000 Aluminum Profile

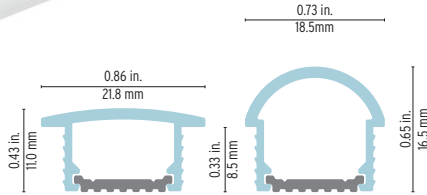
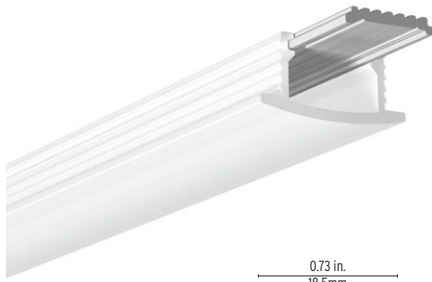

The 5000 profile consists of an aluminum heatsink base inserted into a flexible recessed optic. Simple installation with the assembly inserted into the recess and staying in place due to the gripping ribbed optic sides. The 5/8" wide and 3/8" deep recess is a direct fit for North American cabinetry, closet, or mural applications.

## Features

- Delivered in standard 6.5 ft (2m) length.
- Available as factory assembled complete fixture. See page 2 for details.
- Designed to give a uniform light with the 5200 round optic.
- The 5200 (round) optic has a 0.31 inch (8mm) wall offset, while the 5300 (flanged) optic stands out 1/10" (2.5mm).
- The LED heatsink base is made of aluminum for improved heat dissipation.
- The recess hole should be 5/8" (15.9mm) wide and 8.5mm (1/3 inch) deep minimum.
- Designed to meet North American woodworking standards.

Project name

Fixture type

Specifier

Phase

Date



## Linear weight:

0.035 lbs/ft (without optic)

Cable Feed: End (E)

Max 3.1 W/ft

## Order Code

Family	Profile	Optic
VarioContour	5000	

## Assembly Dimensions [mm] in

WITHOUT OPTIC

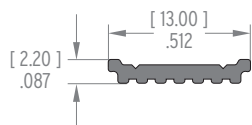

WITH ROUND OPTIC

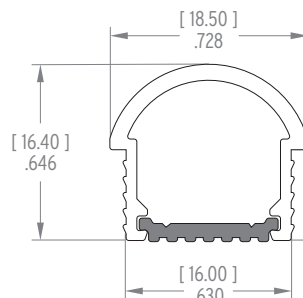

WITH FLANGED OPTIC

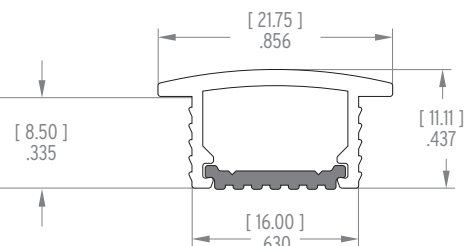

## Order Code - Factory Assembled Fixture

Family	LED Tape Order Code	Profile Component Order Code <sup>A</sup>	Cable/Connector	Cable Position <sup>B</sup>	Custom Length (mm)	Ingress
VarioLED	Refer to LED Tape Spec Sheet	Refer to Profile Spec Sheet (Page 1)	<b>A</b> - Female and Male IP20 Connector (4 in) <b>B</b> - Male IP20 Connector on one side (4 in) <b>C</b> - Open end cable lead on both sides (2 ft) <b>D</b> - Open end lead on one side (2 ft)	E - Cables from end of fixture	Refer to Custom Tape Length Chart Below (insert L)	IP20

### Example

VarioLED	Hydra HD15 W830	1200 1269 1280	A	B	1969	IP20
----------	-----------------	----------------	---	---	------	------

### Custom Length (L)

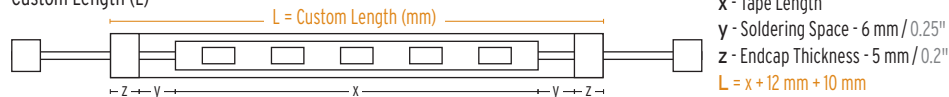

### Cable Position

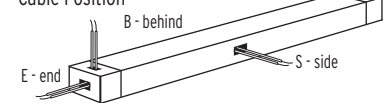

Tape Length (x) Chart <sup>C,D</sup>	Min. Tape Length	Max. Tape Length	Tape Increment
Luminaris LD	70 mm / 2.76"	1970 mm / 77.56"	70 mm / 2.76"
Luminaris HD	70 mm / 2.76"	1970 mm / 77.56"	70 mm / 2.76"
Hydra LD	125 mm / 4.92"	1885 mm / 74.21"	125 mm / 4.92"
Hydra HD	62.5 mm / 2.46"	1947 mm / 76.67"	62.5 mm / 2.46"
Hydra LD Tunable White	125 mm / 4.92"	1885 mm / 74.21"	125 mm / 4.92"
Hydra LD RGB	125 mm / 4.92"	1885 mm / 74.21"	125 mm / 4.92"
Hydra HD RGB	62.5 mm / 2.46"	1947 mm / 76.67"	62.5 mm / 2.46"

<sup>A</sup> Do not need to specify endcaps. Factory assembled fixtures come with endcaps to match the selected optic, cable and connector configurations.

<sup>B</sup> Some cable positions may not be available for certain models. See profile spec sheets for details.

<sup>C</sup> Maximum fixture length is 6.5 ft (2m) for all models.

<sup>D</sup> For custom fixture length, add 5 mm / 0.2" for each endcap thickness and 6 mm / 0.25" for soldering space.