

# RecessedMount Shallow - Assembled Fixture



Compact and recessed fixture. The edges on each side of this fixture allow for a recessed installation, while having style with its discreet and neat appearance.

### Features

- Allows recessed installation (in 3/4 in. groove).
- Designed to meet North American woodworking standards.
- Made of ALCOA 6063-T5 aluminum alloy increasing heat dissipation.
- Compatible with multiple installation accessories.
- Only available in North America.

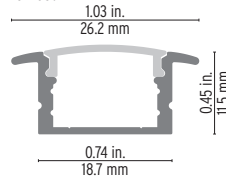

Project name \_\_\_\_\_

Fixture type \_\_\_\_\_ Phase \_\_\_\_\_

Specifier \_\_\_\_\_ Date \_\_\_\_\_

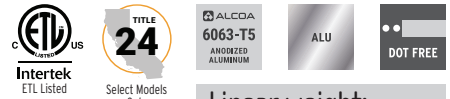

**Linear weight:**  
0.12 lbs/ft (without optic)

**Cable Feed: Behind (B)**  
Max 4.7 W/ft

## Order Code

Family	LED Tape <sup>1</sup>	CRI	CCT	Profile	Finish	Optic	Cable / Connector	Cable Position	Mounting <sup>3</sup>	Fixture length (mm)	Ingress
VarioLED	-----	W_	---	1300	—	---	---	—	---	-----	IP20
	Nexus HD6-1.8 w/ft, 155 lm/ft	W8 85CRI	22 2200K <sup>2</sup>	1300	S Silver	CL Clear	FM Female & Male (4")	B Behind	FMC Flat Mounting Clip	Refer to length chart on page 3	IP20
	Nexus HD10-2.9 w/ft, 250 lm/ft	W9 95CRI	27 2700K		B Black	SP Spread	MS Male one side only (4")		45C 45° Mounting Clip		
	Nexus HD15-4.7 w/ft, 400 lm/ft		30 3000K		C Custom <sup>4</sup>	SO Semi-Opal	OB Open Cable both sides (6")		AT Adhesive Tape		
			35 3500K			OP Opal	OS Open Cable one side only (6")				
			40 4000K			PR Prime					
			50 5000K <sup>2</sup>								

<sup>1</sup> Lumen Values @3000K with Clear Optic    <sup>2</sup> Available only in 85CRI.    <sup>3</sup> See Components spec sheet for details.    <sup>4</sup> Provide RAL code for custom finish.

## LED Tape Specifications

Color vector graphic

Color distortion graphic

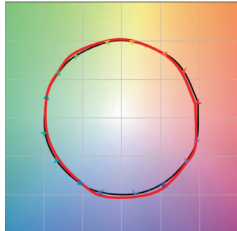

R<sub>r</sub> 92  
R<sub>g</sub> 101  
CRI 95  
R9 85

2200 2700 3000 3500 4000 5000 Kelvin

HD - High density / 8.93 mm LED pitch



L90/B10  
> 60,000 h

Wxxx/  
339

— Reference illuminant    — Test source @ 3000K

		HD6		HD10		HD15		Power (W/ft) <sup>B</sup>	HD6	HD10	HD15
		CCT	Lumen/ft <sup>A</sup>	W/ft <sup>B</sup>	Lumen/ft <sup>A</sup>	W/ft <sup>B</sup>	Lumen/ft <sup>A</sup>				
Static White	● W822	2,200 K	140	1.8	240	2.9	390	1.8	2.9	4.7	
	● W927	2,700 K	150	1.8	260	2.9	410	109	115	118	
	● W930	3,000 K	160	1.8	260	2.9	420	95 / 75	95 / 75	95 / 75	
	● W935	3,500 K	160	1.8	270	2.9	430	95 / 100	95 / 100	95 / 100	
	● W940	4,000 K	160	1.8	270	2.9	440	122°F / 50°C	122°F / 50°C	113°F / 45°C	
	● W850	5,000 K	190	1.8	340	2.9	550				

<sup>A</sup> Lumen values represent bare LED tape without any optics. Refer to page 2 to calculate lumens for each optic option by using the light efficiency percentages.

<sup>B</sup> The given data are typical values. Due to tolerances of the production process and the electrical components, values for light output and electrical power can vary up to 10%.

## Technical Details

### CLEAR

96.5% light efficiency

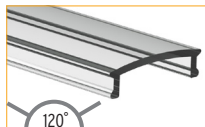

**Visible dotting**  
CCT decrease 65 K

This basic lens protects your tape and maximizes light output.

### SPREAD

95% light efficiency

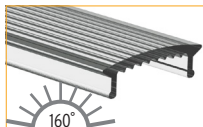

**Visible dotting**  
CCT decrease 65 K

With its integrated prismatic grooves this lens scatters the light and increases the beam spread to better light nearby objects.

### SEMI-OPAL

85% light efficiency

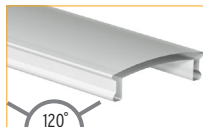

**Slight Visible dotting**  
CCT decrease 130 K

This lens reduces glare and softens light cut-off while maintaining high brightness.

### OPAL

50% light efficiency

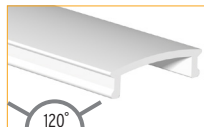

**Dot free**  
CCT decrease 215 K

This lens provides dot free illumination and a homogenous line of light.

### PRIME

85% light efficiency

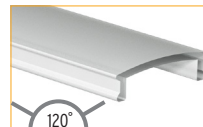

**Dot free**  
CCT decrease 130 K

This lens reduces glare and softens light cut-off while maintaining high brightness.

## Mounting Dimensions [mm] in



**FMC**  
Flat Mounting Clip

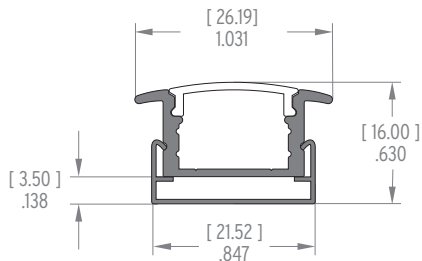

**45C**  
45° Mounting Clip

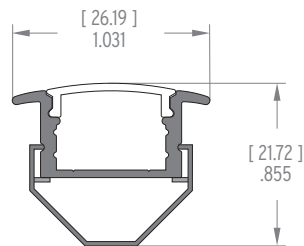

**AT**  
Adhesive Tape

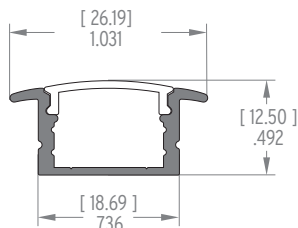

## LENGTH CHART

Fixture length		HD6 1.8 Watts/Ft		HD10 2.9 Watts/Ft		HD15 4.7 Watts/Ft	
inches	mm	Watts/fixture	Lumens/fixture @3000K	Watts/fixture	Lumens/fixture @3000K	Watts/fixture	Lumens/fixture @3000K
3.2	83	0.5	42	0.8	68	1.2	108
5.7	145	0.9	74	1.4	119	2.2	190
8.2	208	1.2	105	2.0	170	3.1	272
10.6	270	1.6	137	2.7	221	4.1	354
13.1	333	2.0	169	3.3	273	5.0	436
15.6	395	2.3	201	3.9	324	6.0	518
18.0	458	2.7	233	4.5	375	6.9	600
20.5	520	3.1	264	5.1	426	7.8	682
22.9	583	3.4	296	5.7	478	8.8	764
25.4	645	3.8	328	6.3	529	9.7	846
27.9	708	4.2	360	7.0	580	10.7	928
30.3	770	4.5	391	7.6	631	11.6	1010
32.8	833	4.9	423	8.2	683	12.6	1092
35.2	895	5.3	455	8.8	734	13.5	1174
37.7	958	5.7	487	9.4	785	14.4	1256
40.2	1020	6.0	519	10.0	836	15.4	1338
42.6	1083	6.4	550	10.7	888	16.3	1420
45.1	1145	6.8	582	11.3	939	17.3	1502
47.5	1208	7.1	614	11.9	990	18.2	1584
50.0	1270	7.5	646	12.5	1041	19.2	1666
52.5	1333	7.9	677	13.1	1093	20.1	1748
54.9	1395	8.2	709	13.7	1144	21.0	1830
57.4	1458	8.6	741	14.3	1195	22.0	1912
59.8	1520	9.0	773	15.0	1246	22.9	1994
62.3	1583	9.3	805	15.6	1298	23.9	2076
64.8	1645	9.7	836	16.2	1349	24.8	2158
67.2	1708	10.1	868	16.8	1400	25.8	2240
69.7	1770	10.5	900	17.4	1451	26.7	2322
72.1	1833	10.8	932	18.0	1503	27.6	2404
74.6	1895	11.2	963	18.6	1554	28.6	2486
77.1	1958	11.6	995	19.3	1605	29.5	2568

## Compatible Drivers

Item	Specifications	Downloads
<b>LED LINEAR™</b> Non-Dimmable Drivers 	<ul style="list-style-type: none"> <li>• UL 8750 Listed Enclosure - With Built-In Junction Boxes</li> <li>• Universal Input Voltage 120V - 277V</li> <li>• IP65 - For Both Indoor and Outdoor Use</li> <li>• No Minimum Load Requirement</li> <li>• 24V Constant Voltage Output, Class 2</li> <li>• Available in three wattages 30W, 60W and 96W</li> <li>• Max. Dimensions: 12-1/8" x 2-3/8" x 1-3/8"</li> </ul>	<a href="#">30 W SPEC SHEET</a> <a href="#">60 W SPEC SHEET</a> <a href="#">96 W SPEC SHEET</a> <a href="#">INSTALLATION INSTRUCTIONS</a>
<b>LED LINEAR™</b> 0-10V Dimmable Drivers 	<ul style="list-style-type: none"> <li>• UL 8750 Listed Enclosure - With Built-In Junction Boxes</li> <li>• 0-10V Dimmable - Flicker Free Down to 1%</li> <li>• Universal Input Voltage 120V - 277V</li> <li>• IP65 - For Both Indoor and Outdoor Use</li> <li>• 24V Constant Voltage Output, Class 2, Class P</li> <li>• Available in three wattages 30W, 60W and 96W</li> <li>• Max. Dimensions: 12-1/8" x 2-3/8" x 1-3/8"</li> </ul>	<a href="#">30 W SPEC SHEET</a> <a href="#">60 W SPEC SHEET</a> <a href="#">96 W SPEC SHEET</a> <a href="#">INSTALLATION INSTRUCTIONS</a>
<b>LED LINEAR™</b> ELV/Triac Dimmable Drivers 	<ul style="list-style-type: none"> <li>• UL 8750 Listed Class 2 Enclosure</li> <li>• 24V constant voltage output</li> <li>• Compact size yet high efficiency and performance in dry and damp environments (IP67)</li> <li>• Multiple Inputs: 120V or 277V</li> <li>• Fully dimmable: ELV Dimmers - Reverse or Adaptive Phase Control, Trailing Edge</li> <li>• Available in two wattages 48W and 96W</li> <li>• Multiple Circuits are available up to 4 units (up to 384W)</li> </ul>	<a href="#">48 W SPEC SHEET</a> <a href="#">96 W SPEC SHEET</a> <a href="#">INSTALLATION INSTRUCTIONS</a>
 <b>MEAN WELL</b> PWM Dimmable Drivers 	<ul style="list-style-type: none"> <li>• Universal AC input / Full range (up to 305VAC)</li> <li>• Constant voltage PWM style output</li> <li>• Built-in 3 in 1 dimming function (0-10Vdc or PWM signal or resistance)</li> <li>• Dimming range : 0-100%</li> <li>• Class 2 power unit</li> <li>• Suitable for dry / damp / wet locations</li> <li>• UL Recognized component, 5 years warranty</li> </ul>	<a href="#">40 W SPEC SHEET</a> <a href="#">60 W SPEC SHEET</a> <a href="#">90 W SPEC SHEET</a> <a href="#">INSTALLATION INSTRUCTIONS</a>
 <b>LUTRON</b> Dimmable Drivers 	<ul style="list-style-type: none"> <li>• UL Listed Enclosure</li> <li>• Dimming Range: 100% to 1% and 0.1% (Premiere)</li> <li>• LED lighting turns on to any dimmed level without flashing to full brightness</li> <li>• Operating Voltage: 120V~ to 277V~ at 50/60 Hz</li> <li>• Rated lifetime of 50,000 hours at 40°C (104°F) ambient temperature and maximum loading</li> <li>• For rated warranty, ambient temperature not to exceed 40°C (104°F)</li> <li>• Open-circuit protected output</li> </ul>	<a href="#">HI-LUME SPEC SHEET</a> <a href="#">HI-LUME PREMIERE SPEC SHEET</a> <a href="#">INSTALLATION INSTRUCTIONS</a>
<b>eldoLED</b> DALI/DMX Dimmable Drivers 	<ul style="list-style-type: none"> <li>• Available in linear or rectangular format</li> <li>• 100W, DMX/DALI interface for Static White, Tunable White and RGB/W Applications</li> <li>• 4 control channels</li> <li>• 24V constant voltage, 4 x 24V outputs</li> <li>• Metal or plastic case options</li> </ul>	<a href="#">100 W SPEC SHEET</a> <a href="#">INSTALLATION INSTRUCTIONS</a>

## Controllers

Item	Specifications	Downloads
<b>eldoLED</b> Controllers 	<b>180/D</b> DMX Controller for RGB/W and Tunable White Applications	<a href="#">180/D SPEC SHEET</a>
	<b>210/D</b> Dali Controller for Static White Applications	<a href="#">210/D SPEC SHEET</a>
	<b>211/D-LG</b> 0-10V Logarithmic Dimming Controller	<a href="#">211/D-LG SPEC SHEET</a>
	<b>211/D-LN</b> 0-10V Linear Dimming Controller	<a href="#">211/D-LN SPEC SHEET</a>
	<b>212/D</b> DMX Controller for Static White and Static Color Applications	<a href="#">212/D SPEC SHEET</a>
	<b>DimWheel</b> DMX Wall Controller for RGB/W and Tunable White Applications	<a href="#">DIM WHEEL SPEC SHEET</a>

Click for more information

NEXUS HD

CONTOUR 1300

VOLTAGE DROP CALCULATOR

INSTALLATION

LED LINEAR TECHNOLOGY