

INSTALLATION INSTRUCTIONS

MODELS: LUMINARIS, HYDRA, NEXUS, SOL INDOOR LED FLEX TAPE

LED LINEAR™
lighting solutions

ATTENTION

Please read all safety and assembly instructions prior to installation and keep for future reference.

1. Product should be installed by a qualified electrician with regards to all applicable electrical and safety standards.
2. Ensure power is shut off at the electrical panel prior to installation in order to prevent electrical shock.
3. Use only with SELV (Safety Extra Low Voltage)/Class 2 power supplies.
4. Suitable for installation in Dry Locations.
5. Do not operate the product in rolled-up condition.
6. Avoid looking directly into the light source during operation - glare hazard.
7. Do not store packed units over 70° F and over 50% humidity more than 12 months.



NOTE

Prior to installation, always test the LED tape with a suitable power supply in order to confirm operation and that the factory connections are secure. LED Linear only honors warranty for supplied material and is not liable for installation errors.



I. STAND ALONE TAPE INSTALLATION

1 Handling

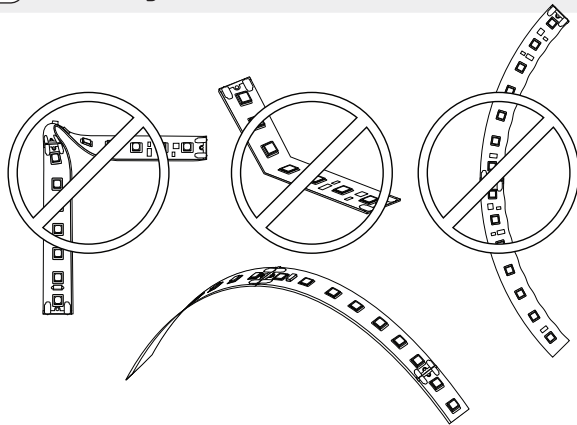

Mechanical stress of the tape must absolutely be avoided. Assembly must not lead to damage or interruption of the circuit paths. Avoid Electrostatic Discharge with proper equipment. Do not attempt to bend the tape horizontally or with sharp edges. The recommended minimum bending radius is 1".

2 Wiring Option 1: Soldering

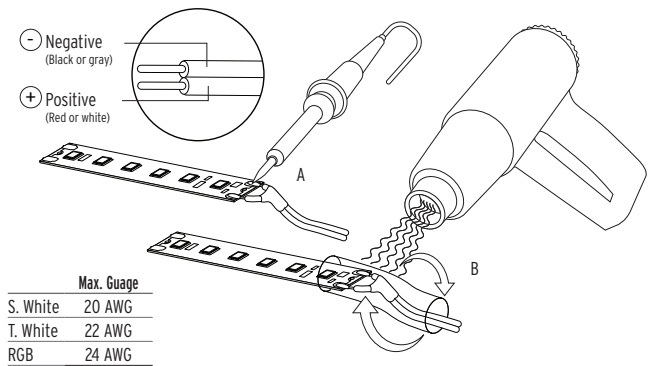

Lead wires can be soldered onto the tape. Solder connections should only be performed manually on designated solder pads that are marked as "24 V" (A). The maximum solder time is 3 seconds and the maximum soldering temperature is 662°F (350°C). After soldering, use shrink tube (provided by others) over the connection and cure with heat gun (B).

3 Wiring Option 2: Quick Connect

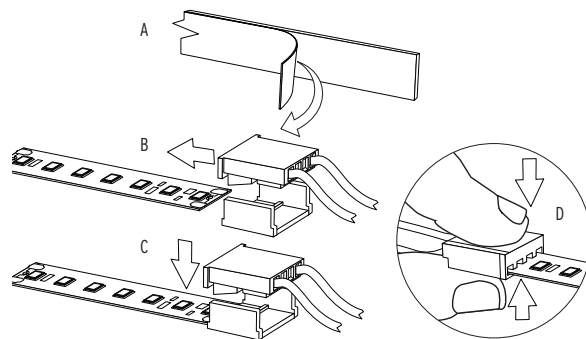

The tape can be connected to Quick Connect terminals supplied by LED Linear. Peel the backing of the tape about half inches (A). Carefully slide the LED tape into the connector (B). Make sure that the polarity is correct: red(+) and black (-). After making sure that the contacts overlap (C), crimp the connectors by pressing tightly (D).

4 Preparing the Surface

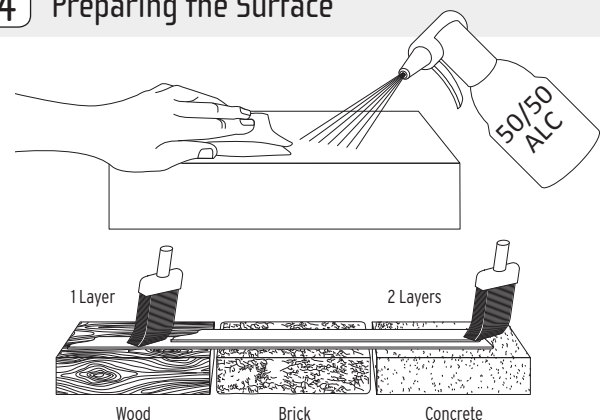

Wipe the surface with 50/50 alcohol solution to provide a clean mounting surface, free of oils, silicones and dirt particles. The mounting surface must have be smooth and have sufficient structural integrity. For porous materials like wood, brick or concrete, optional painting/priming the surface increases bonding power.

INSTALLATION INSTRUCTIONS

MODELS: LUMINARIS, HYDRA, NEXUS, SOL INDOOR LED FLEX TAPE

LED LINEAR™
lighting solutions

ATTENTION

Please read all safety and assembly instructions prior to installation and keep for future reference.



5 Field Cutting

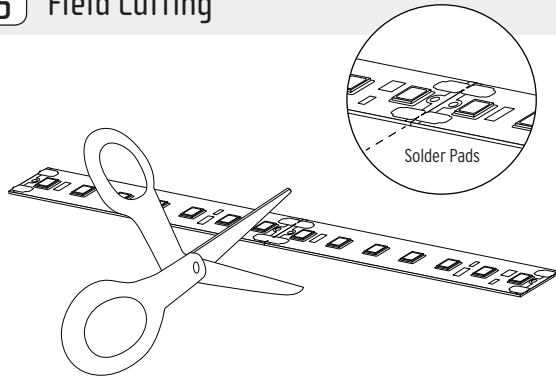

The tape can be cut with a pair of scissors at marked locations in between solder pads. Refer to the product datasheet for exact cut lengths. Always cut from end with no connector/wire leads. Then use either soldering or Quick Connect methods to power cut sections.

6 Installing

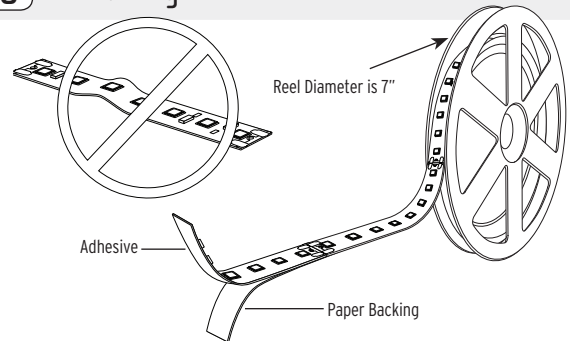

The tape shall only be mounted on surfaces that provide sufficient cooling. Remove the paper backing from the tape and firmly press down onto the surface. Uncoil and peel the minimal amount of tape as you install to avoid collection of debris. Excessive uncoiling and peeling create ripples and air bubbles on the tape that should be avoided.

7 Securing (Optional)

Materials	Suggested Epoxies
Concrete, Stone, Cinderblock, Metal and Brick	Loctite Metal and Concrete Two-Part Epoxy
ABS, Fiberglass, Plastic and PVC	Loctite Plastic Two-Part Epoxy
Tile, Wood, Ceramic, Glass or Metal	Loctite Clear Two-Part Epoxy
All Purpose	Strong Stik

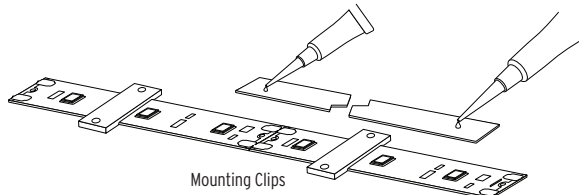

For additional security, use mounting clips every 12" (supplied by others) or apply small amounts of epoxy at each end to increase holding force. Refer to table for recommended epoxy brands. Avoid installing the tape overhead without taking additional securing measures.

8 Powering

Pay attention to the maximum output of the power supply.

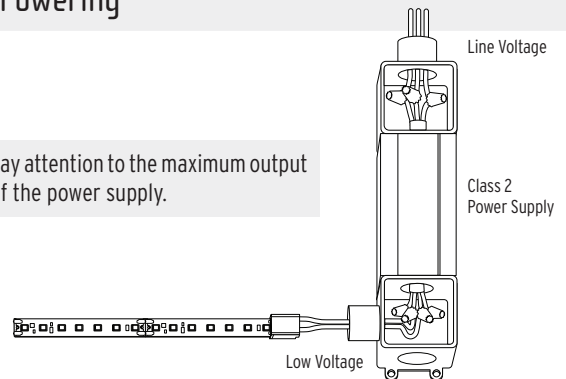

Connect positive wire to RED (white) low voltage wire from power supply. Also, connect negative wires to BLACK (gray) low voltage wire from power supply. Refer to the power supply data sheets for the maximum cable length from power supply to the product.

9 Circuiting

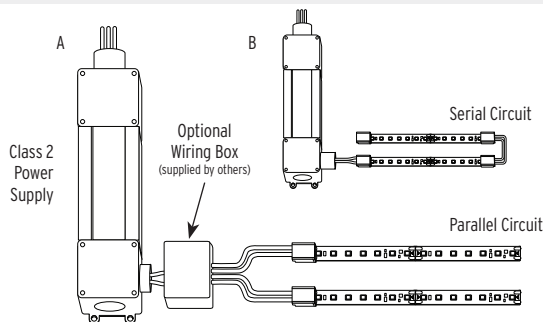

Parallel drive circuits ensure a safer operation (A). Use an optional wiring box to split parallel circuits. Refer to product data sheet for further information. If used with serial circuit (B), the maximum length of a single unit to be driven in series equals the maximum length of the tape. If exceeded, asymmetric voltage drops can lead to a strong over current and damage of single modules.

10 Continuous Circuits

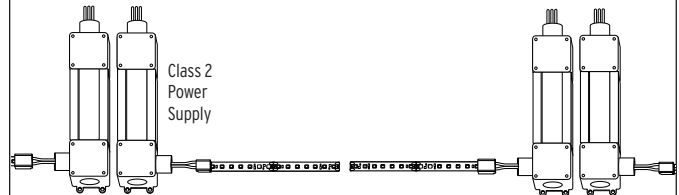

Maximum run length of the tape depends on the power supply specifications. For continuous runs, place the power supplies either at both ends of the run or in the middle of the run next to each other.

INSTALLATION INSTRUCTIONS

MODELS: LUMINARIS, HYDRA, NEXUS, SOL INDOOR LED FLEX TAPE

LED LINEAR™
lighting solutions

ATTENTION

Please read all safety and assembly instructions prior to installation and keep for future reference.



II. INSTALLATION IN ALUMINUM CHANNEL

1 Overview

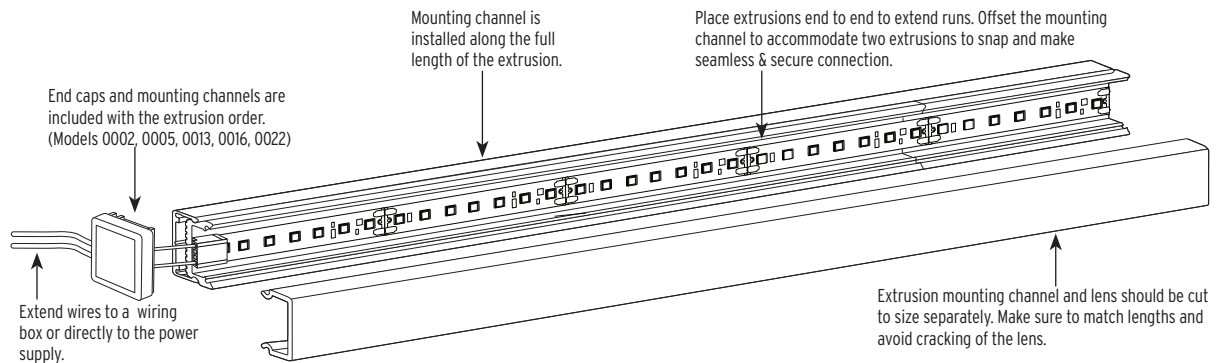

2 Preparing the Surface

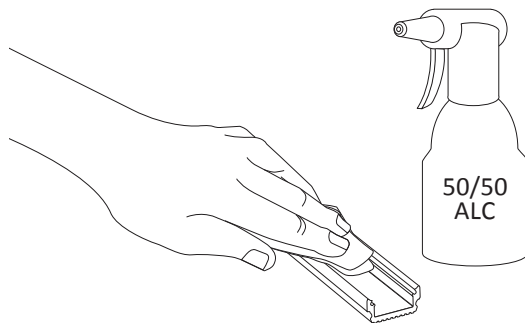

Thoroughly clean the area where tape lights will be installed. Using a 50/50 alcohol mix, clean the area where LEDs will be applied and allow time for alcohol to dry for 5 minutes.

3 Measuring

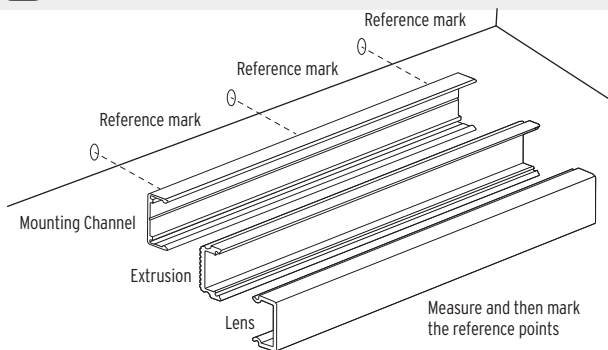

Align the mounting channel to the determined location. Mark reference points to install to the surface. The location of the power supply or wiring box should be determined prior to installation.

4 Field Cutting

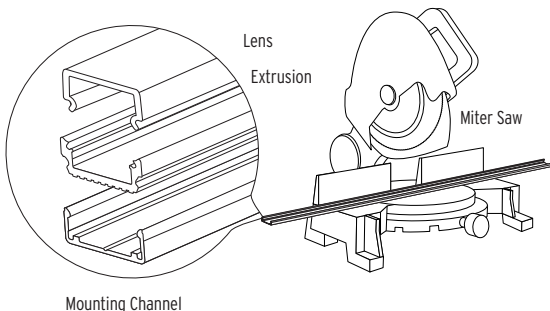

Cut extrusion, lens, & mounting channel to the desired length in the field. For short runs (<78"), cut all parts to the same length by using the proper blades for aluminum/plastic cut. For longer runs it is recommended to cut the mounting channel longer than the extrusion to accommodate end to end connections.

5 Assembling Fixture

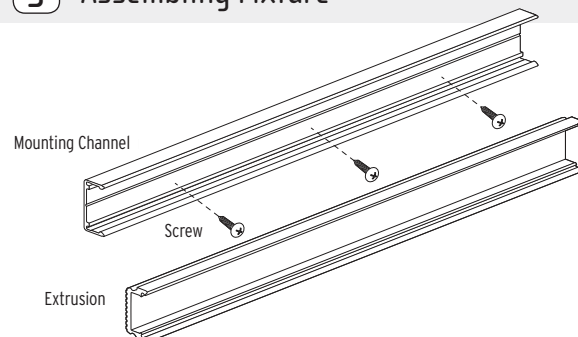

Lay mounting channel onto the surface along the pre-determined locations and secure using the screws provided by others. Using the mounting bracket is necessary for relevant models (0002, 0005, 0013, 0016, 0022). Gluing the channel to surface without using the mounting bracket should be avoided. Snap the channel into the mounting channel. Offset them for longer runs.

INSTALLATION INSTRUCTIONS

MODELS: LUMINARIS, HYDRA, NEXUS, SOL INDOOR LED FLEX TAPE

LED LINEAR™
lighting solutions

ATTENTION

Please read all safety and assembly instructions prior to installation and keep for future reference.



6 Assembling Fixture

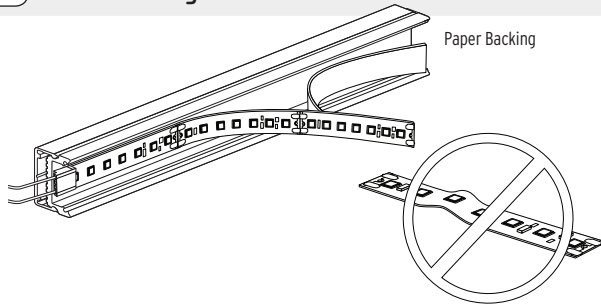

Attach the quick connector or solder lead wires to one side of the tape. Shorten the LED tape to desired length by cutting along the marked area in between the solder pads. Remove paper backing from the adhesive tape firmly press down onto the aluminum surface. Uncoil and peel minimal amount as you install to avoid collection of debris. Excessive uncoiling and peeling of tape create ripples and air bubbles on the tape that should be avoided.

7 Installing Lens

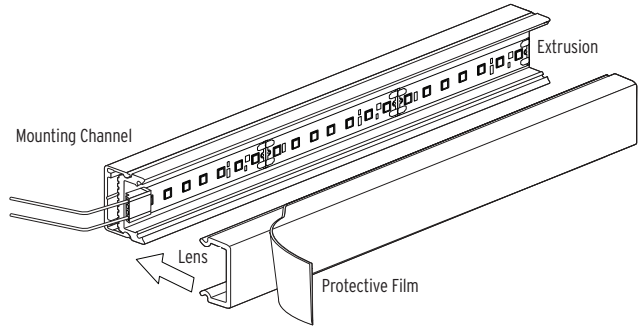

Snap the diffuser lens into the aluminum extrusion. Remove the protective film from the diffuser lens.

8 Installing Endcaps

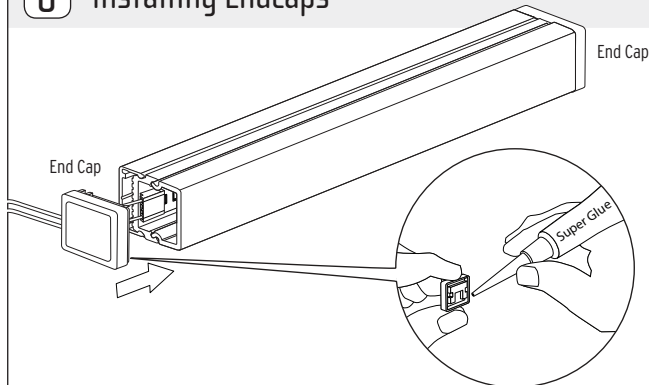

Feed the lead wires through or behind the endcap. Add Super Glue inside and around end cap to secure it in place. For select models, use torque bit to screw the endcap. If applicable, secure the Quick Connector by adding super glue and pressing it onto the extrusion.

9 Powering

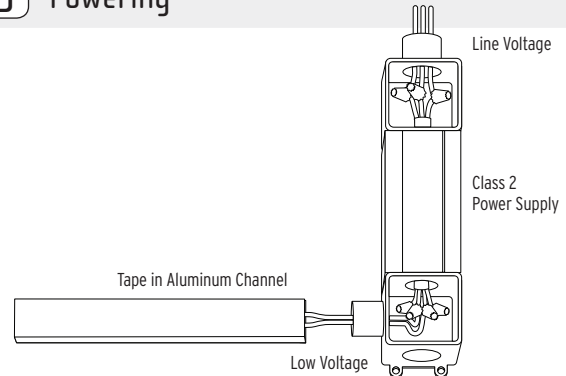

Ensure the correct (wattage & voltage) power supply is used to power the tape. Then proceed to connect low voltage wires from extrusion to power supply. For more information please refer to power supply and LED tape wiring instructions.