

HYDRALUX Assembly, accessory and safety information

The entire LED Linear™ product portfolio is made for an easy and fast installation in rugged environments. To assure a high installation quality please study the following pages for the

safety and installation of LED Linear™ HYDRALUX carefully. Our worldwide located branches and distributors will be happy to assist you regarding your installation questions.

Assembly information

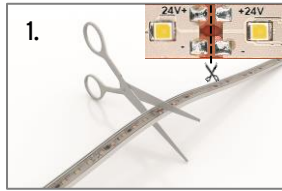

1. Unpack product/set and verify its contents. Warning: Operation of the product in rolled-up condition is not allowed. Unroll the tape and cut it at the desired length in the middle between the steps. Make sure that a minimum bending radius of 3 cm is observed.

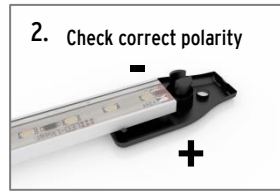

2. Check correct polarity
Insert the tape into the lower part of the two-part connector. The correct polarity must be strictly observed.

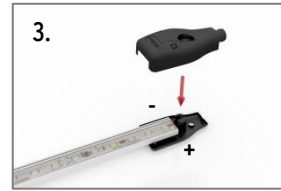

3. Place the upper part of the connector on the lower part of the connector.



4. Now click together the upper and the lower part of the connector. Make sure that no gaps occur at the sides. The product is now ready to be connected in indoor areas.



5. Before performing this step, protective gloves have to be put on and the safety information have to be read. For exterior use an additional seal still needs to be done. Therefore the connector needs to be filled with a sealant, which can be filled in with a syringe through a filling hole on the underside of the connector. The mixing tube should only be used if as many connectors as possible are ready for sealing. If the mixing tube isn't used for about 2 hours, the sealant inside is dried. Then a new mixing tube must be attached for the further use of the sealant in the double cartridge.



6. The filling must be done carefully and slowly. If filling material comes out of the small hole, the connector is fully filled with sealant. Further filling with sealant can cause that the connector parts are pressed apart or that sealant is exiting at other locations. When sealant is on surfaces on which it is not intended to harden, it should be removed with a damp cloth within 7 minutes. The sealant has dried after 2 hours and completely hardened after 8 hours.



7. To ensure an IP67 protection at the other end of the product, the end cap must also be sealed. For this purpose, a narrow strip of sealing compound is applied to the cutting edge. Then the end cap is placed over it.



8. By applying the connector on one side and attaching the end cap on the other side, the product is ready for connection.



9. The attachment of HYDRALUX can be done with the VarioClips. To mount the clips countersunk screws and screws with a diameter of above 3 mm are not suitable. Alternatively, an adhesive tape can be used for attachment.

Accessory information



or



or



optional



- HYDRACON Mono Kit
Art. # 15000221
- HYDRACON RGB Kit
Art. # 15000222

- HYDRACON Mono Male Connect 0,115 Kit
Art. # 15000192
- HYDRACON RGB Male Connect 0,115 Kit
Art. # 15000194

- HYDRACON Mono 2 x 0,34 mm Kit
Art. # 15000193
- HYDRACON RGB 4 x 0,25 mm Kit
Art. # 15000195

- For IP67:
- HYDRACON Encapsulation Kit
Pro Art. # 18200065

- For IP67:
- HYDRACON Encapsulation Pistol
Art. # 13100004

- HYDRACON End Cap
Art. # 11000116

- Mounting:
- VarioClip Flex 12,5mm Clear (set of 50)
Art. # 13000115
 - 3M adhesive tape (10m)
Art. # 18200035

Further details on the accessories can be found in the data sheets of the products.

Safety information

- Please read the safety and assembly information and the corresponding references carefully.
- Mechanical stress on the flex tape and its components has to be absolutely avoided.
- Operation of HYDRALUX in rolled-up condition is not allowed.
- Assembly must not lead to damage or interruption of the circuit paths.
- Power supply units used for operation should ensure the following basic protection and safety features: Short-Circuit Protection, Overload Protection, Overheat Protection, SELV equivalent (Safety Extra Low Voltage)/Class 2
- When commissioning please pay attention to the correct polarity. Wrong polarity can destroy the modules.
- Pay attention to the maximum output of the power supply.
- Installation of LED modules (with power supplies) needs to be made with regards to all applicable electrical and safety standards. Only qualified personnel should be allowed to perform installations.

- Avoid Electro-Static-Discharge.
- Do not look directly into the bright light source.
- HYDRALUX is protected against humidity and dust.
- HYDRALUX can be cut with a pair of scissors at marked locations according to the datasheet.
- During adhesion of the product, use only dry and clean surfaces that are free of grease, oil, silicone and dirt particles.
- Avoid adhesive bonding overhead without additional fixing measures. If necessary use additional fixing for installation.
- The minimum bending radius is 3 cm.
- The maximum cable lengths for product installation emerge from the tables in the system catalog 2014/2015 on page 414 ff.